

Column



Removal

1. Remove the steering wheel.
2. Remove the cover panel.
3. Remove the steering joint cover.
4. Remove the lower steering joint bolt.
5. Remove the lower column bracket.
6. Remove the nuts attaching the bending plate guide and bending plate.
7. Remove the upper column cover and disconnect each wire coupler.
8. Remove the steering column assembly.

NOTE: The tilt steering column is shown; the conventional steering column is similar except for the tilt mechanism.

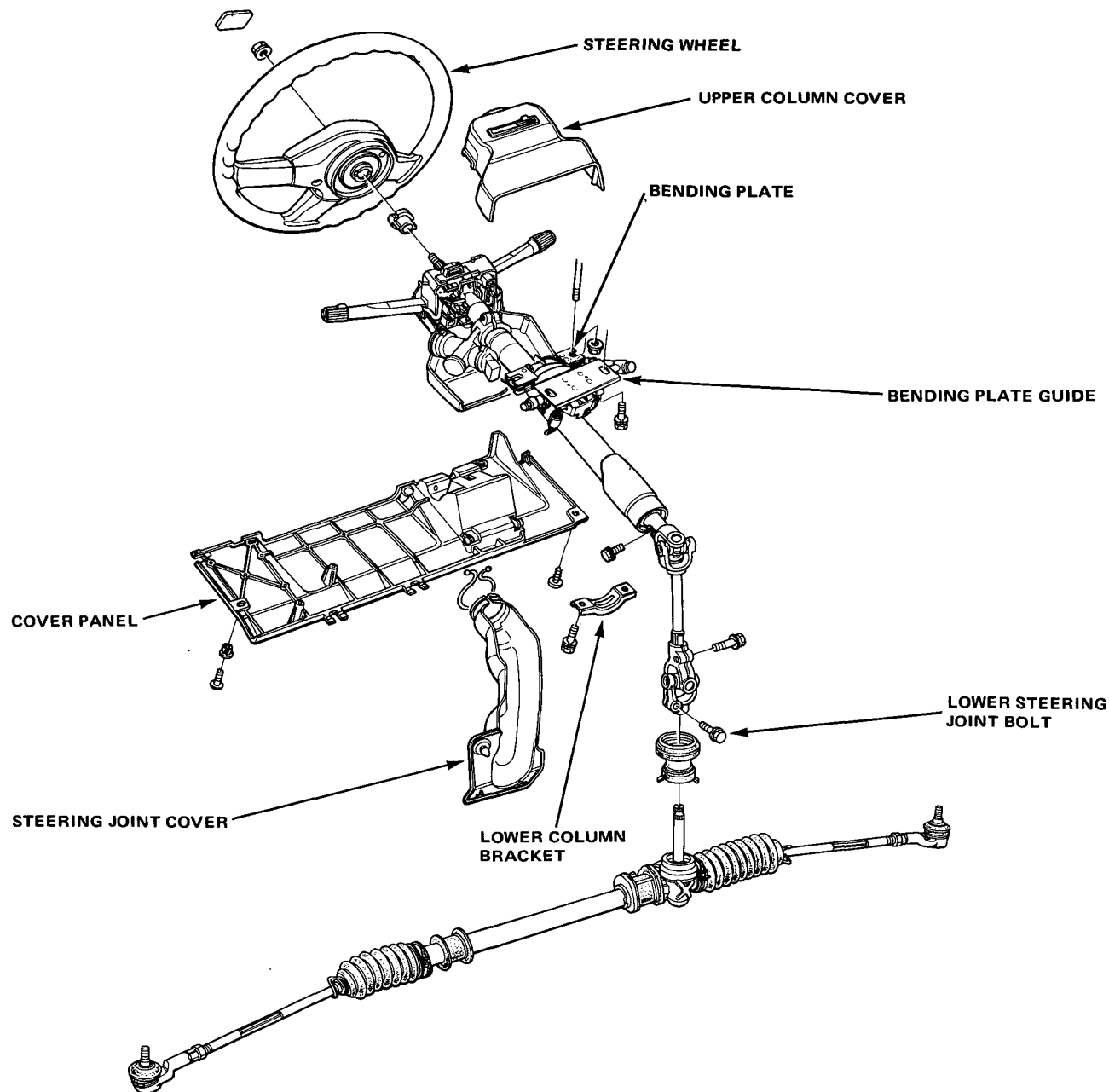

Column

Disassembly/Inspection

1. Remove the turn signal cancelling sleeve.
2. Remove the rubber band, then remove the upper column holder and bending plate.
3. Remove the bending plate guide.
4. Remove the combination switch.
5. Turn the ignition switch to the "I" position.
6. Remove the horn contact.
7. Pry off the circlip and pull down on the steering shaft.

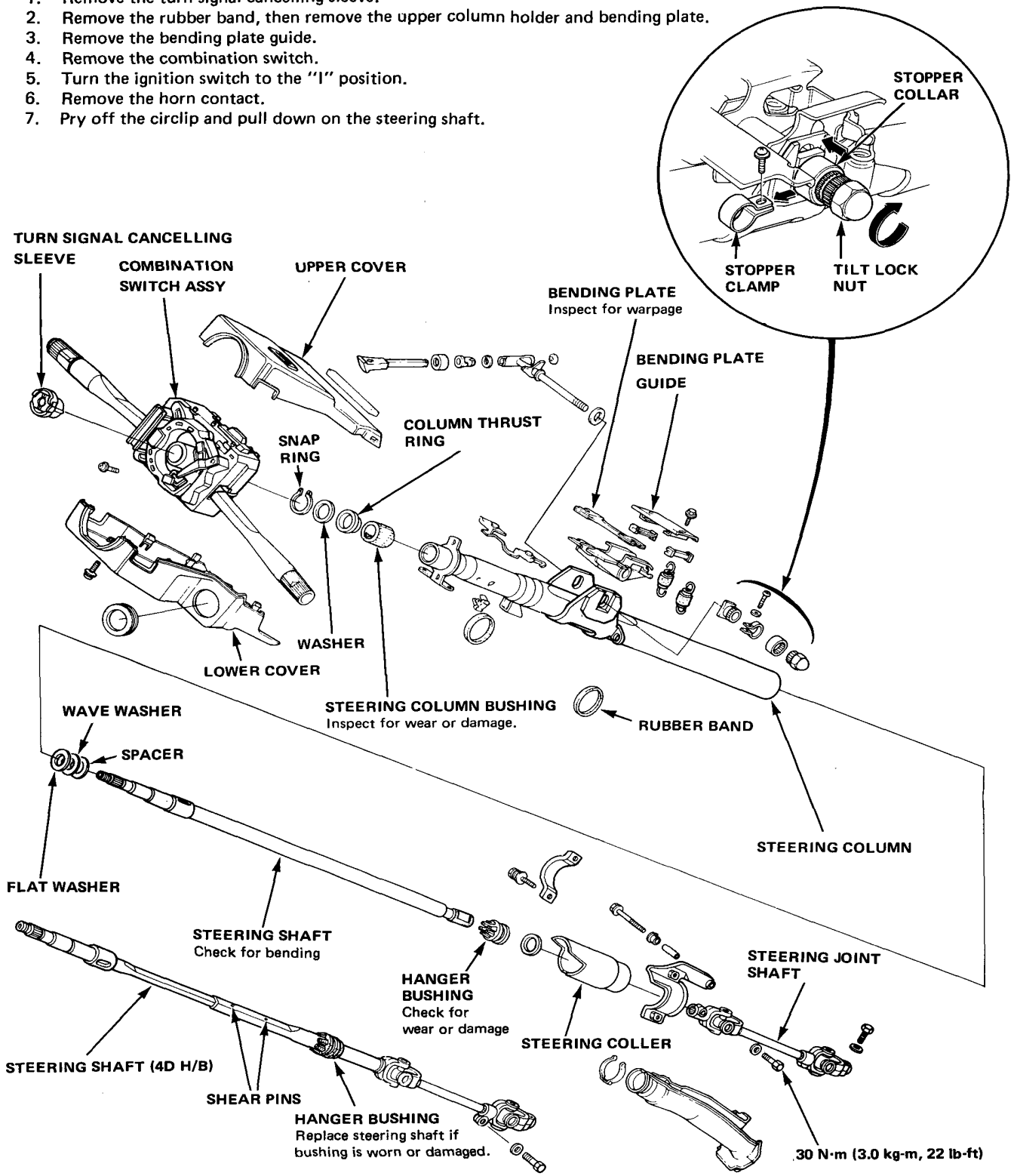



Reassembly

1. Insert the column bushing.
2. Set the steering thrust ring in position.

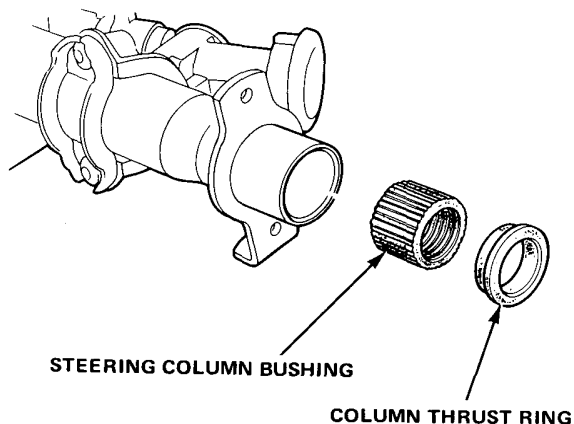

3. Apply grease to the column bushing and its thrust ring.
4. Coat the steering shaft with rest-preventive oil.
5. Install the spacer, spring washer, and flat washer on the end of the steering shaft.

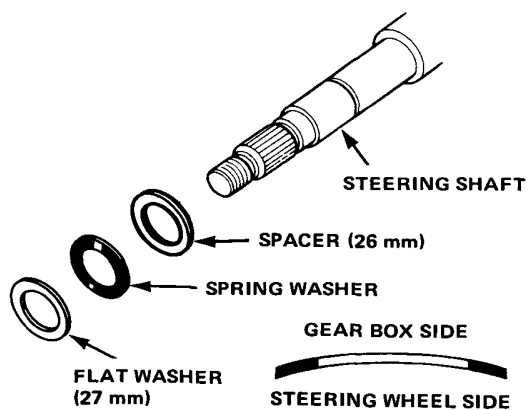

6. Carefully insert the steering shaft in the steering column from the bottom.
7. Install the retaining washer and snap ring on the steering shaft.

8. Install the horn contact.

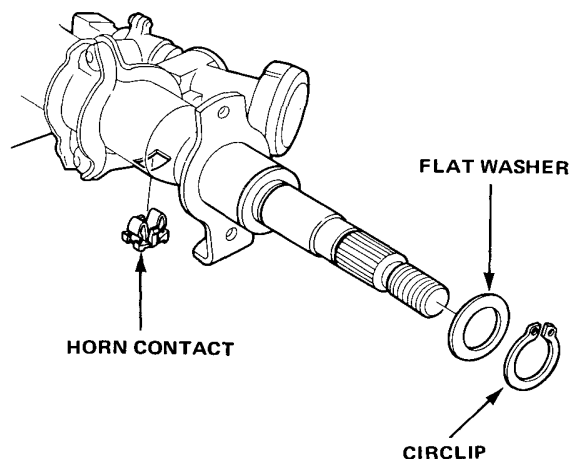

9. Apply grease to the lower end of the steering shaft and inside of the column.
10. Push the hanger bushing into the bottom end of the column as far as it will go.

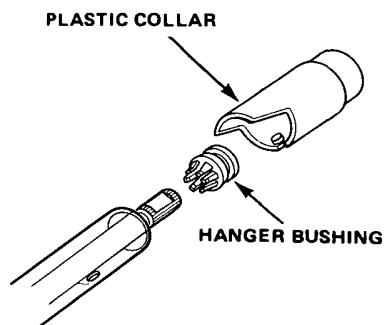

11. Install the plastic collar over the bottom end of the steering column by aligning the round projection inside the collar with the hole in the column.

(cont'd)

Column

Reassembly (cont'd)

12. Install the combination switch assembly.

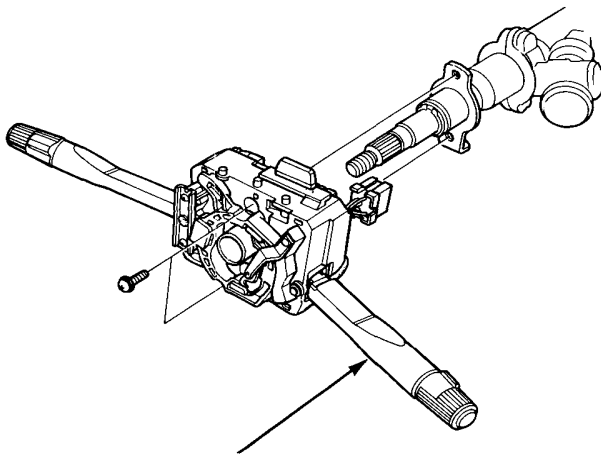

COMBINATION SWITCH ASSEMBLY

13. Install the turn signal switch (4 screws) and turn signal cancelling sleeve.

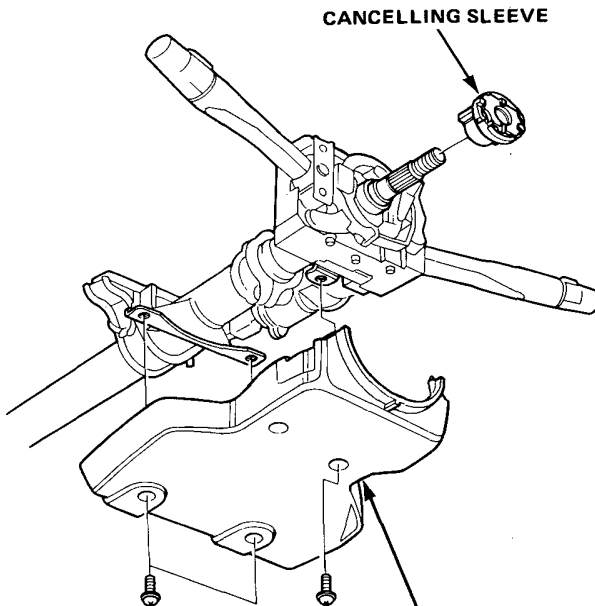

**COLUMN
LOWER COVER**

14. Install the column upper cover and lower cover.

15. If applicable, assemble the tilt lever.

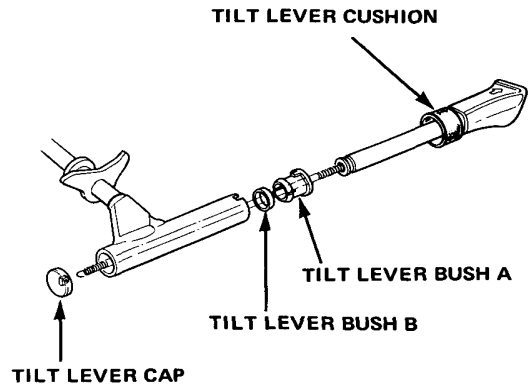

16. Position the bending plate on the steering column; if applicable insert the tilt lever shaft into the column with the washer as shown.

NOTE: Coat sliding surfaces with clean grease.

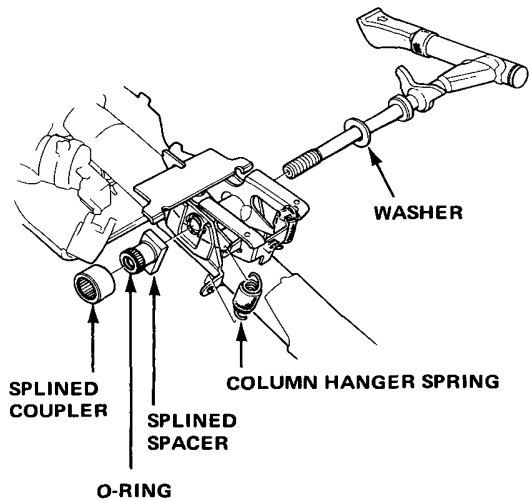

17. If applicable, install the splined spacer on the tilt shaft.

NOTE: Avoid damaging the O-ring.

18. Slide the splined coupler onto the splined spacer.
19. Install the column hanger spring.



20. If applicable, tighten the tilt lock nut to 7 N-m (0.7 kg-m, 5 lb-ft) then slide the splined coupler toward the tilt lock nut until it stops.

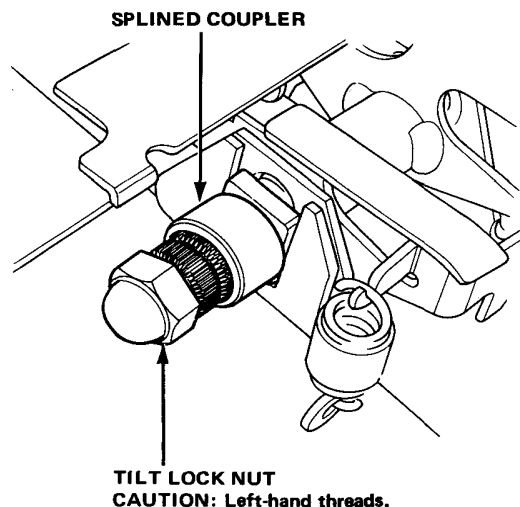

NOTE: To align the splines on the locknut and the spacer, turn the tilt shaft slightly.

21. If applicable, pull the tilt lever knob out fully and measure the force required to move the lever. Attach the spring scale 35 mm (1.38 in) from the end of the knob.

OPERATING FORCE: 5.9–9.0 kg (11–20 lbs)

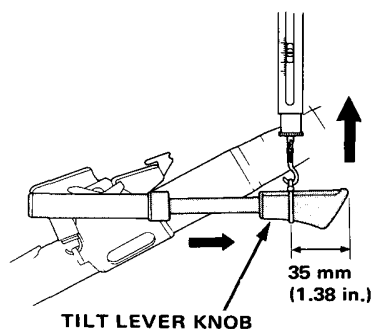

22. If the force measured does not fall within the specification, slide the splined coupler toward the splined spacer, and tighten or loosen the tilt locknut until the correct force is obtained.

NOTE: Turning the locknut counterclockwise will increase the force required.

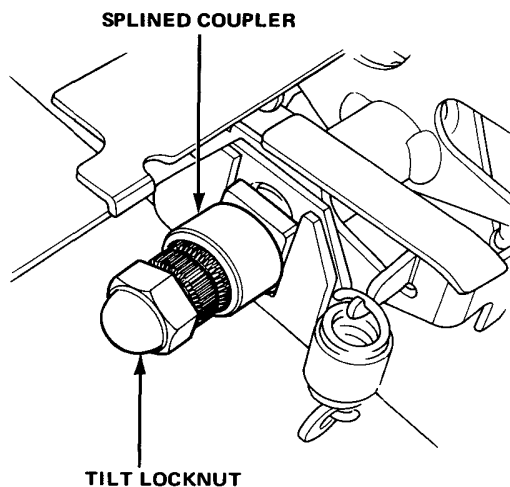

23. Slide the splined coupler toward the tilt locknut.
24. Install the lock clip.

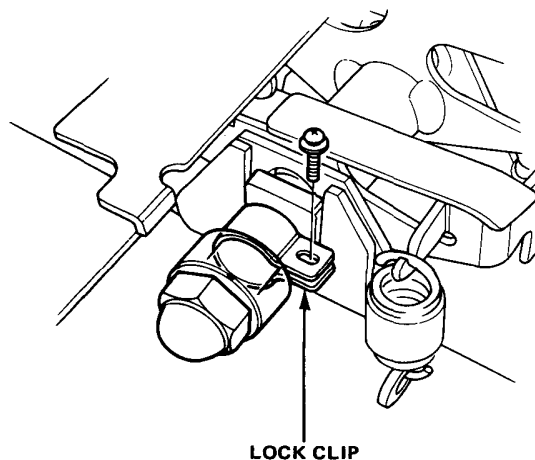

(cont'd)

Column

Reassembly (cont'd)

25. Install the bending plate guide. Secure the upper column holder and bending plate with the rubber bands. (Tilt steering column)

NOTE: Install the bending plate and plate guide with the arrows facing toward the steering gearbox.

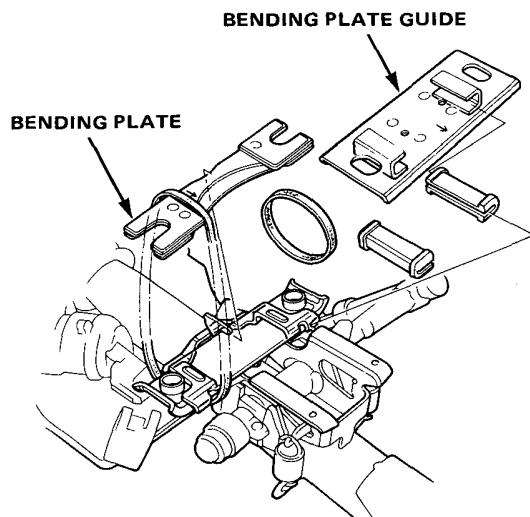

- Install the upper column bracket, bending plate and rubber bands. (Conventional steering column)

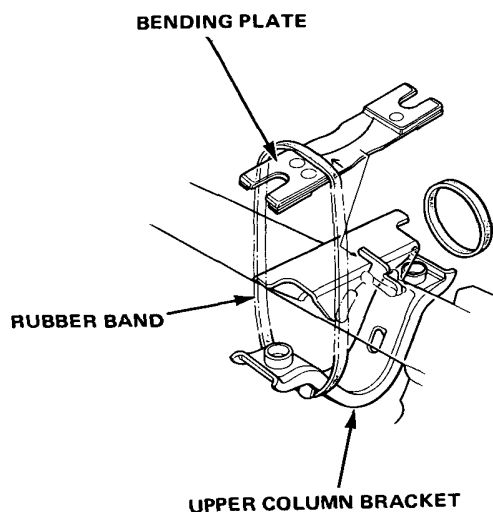

26. Slide the plain washer and steering joint onto the steering shaft aligning the cutout in the shaft with the hole in the joint. Insert the set bolt through the hole, pull the joint as far down as possible, and temporarily tighten the bolt (except for 4D H/B).

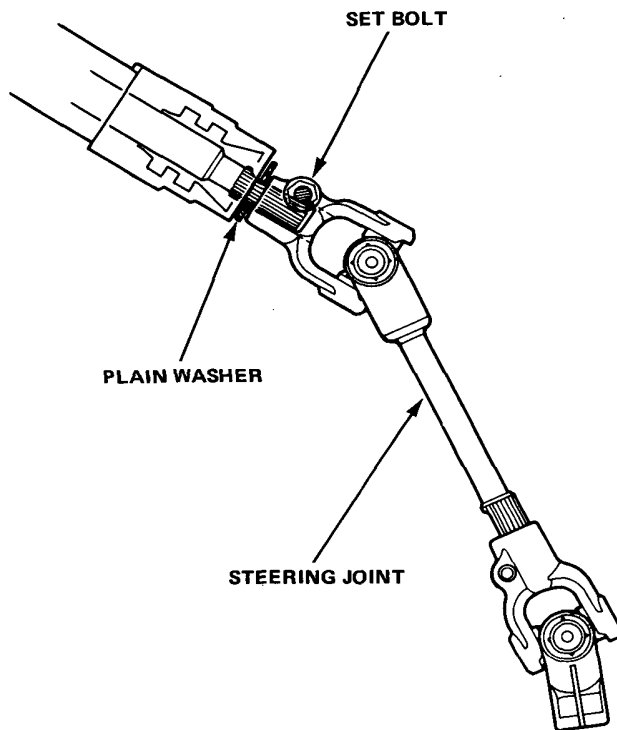



Installation

1. Slide the steering joint onto the steering pinion and loosely install the mount bolt.
2. Reconnect the wire couplers.
3. Install the column upper cover.
4. Insert the frame studs into the holes of the bending plate guide and plate and secure with the mount nuts.
5. Tighten the steering joint lower bolt.
6. Tighten the steering joint upper bolt.
7. Install the cover panel.
8. Install the steering wheel.

